

242

W-242

10/16/1907

From U.S. Geological Folio 138

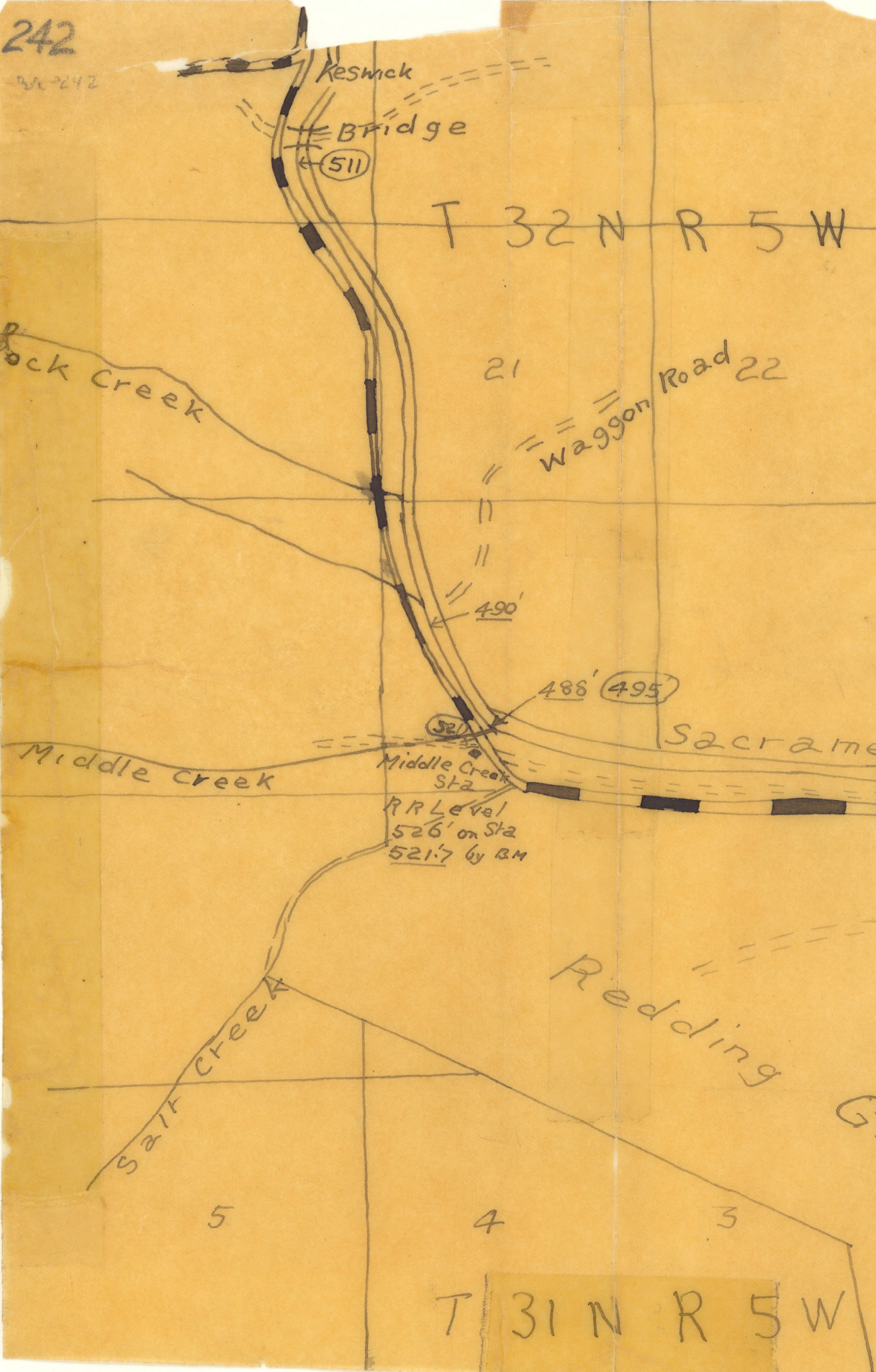

	Date 1900	Elevation Ft	Dist mi	Fall per mile Ft
Kennet Bridge	July 20	624'	12	9
Keswick Bridge	July 20	511	2	8
Middle Creek Jctn	July 20	495	6	6.5
Redding Bridge	July 4	456	100+	2

Numbers O u.s. Geol. Sur  
 — Instrument Levels

THIS IS A  
 COPY OF THE  
 ORIGINAL  
 FILED IN  
 THE  
 U.S. GEOLOGICAL SURVEY  
 OFFICE OF THE CHIEF OF BUREAU OF GEOGRAPHIC NAMES  
 WASHINGTON, D.C.

Sacramento River  
 at Redding, Calif.